

# Packaging Design Software

# PackZ



## Features & Benefits

Interactive drawing toolset for enhanced usability and increased productivity.

Extensive library of reusable parametric designs styles.

Drag and drop components that reduce design time.

Advanced 3D modeling and animation tools.

Powerful and efficient layout and tooling design features.

SQL database driven.

Industry standard data import and export functions.

PackZ is the complete packaging design solution, with everything you need in one software package. Combining powerful design functionality with fully integrated 3D proofing and presentation, and streamlined production capabilities, PackZ software will compliment your Zünd digital cutting system perfectly.

Contact us for a personal demonstration and see the difference for yourself.

## Packaging Perfected.

**Zund Plotting Systems (UK) Ltd**

Unit 1, Spring Valley Business Centre, Porters Wood, St. Albans, Hertfordshire. AL3 6PD.

zund.co.uk Tel: +44 (0)1727 833 003 Fax: +44 (0)1727 833 006 Email: sales@zund.co.uk

**ZÜND**  
swiss cutting systems

## Database Driven Packaging Design and Manufacturing Software

PackZ is the packaging industry's most versatile program for the design of paper-based packaging, point of sale displays and production tooling. Whether you're an independent or a multi-national enterprise; involved in short run or high volume production; work with solid board, in corrugated or in plastics; PackZ has all you need to set your company apart from the competition.



## Packaging Perfected

PackZ is the system of choice for a growing number of the world's leading packaging and display manufacturers who understand that the key to successful structural design is differentiation and innovation. Packaging and point of sale displays need to communicate the brand owner's message effectively, which is why PackZ bundles come complete with the packaging industry's most automated and powerful features for structural design, product development and virtual 3D sampling. Together these features provide designers with all the tools they need to deliver creative solutions that meet the combined demands of structure, product and environment perfectly.

PackZ features a set of fully interactive drawing tools as well as a wide range of reusable design components, which make the creation of custom drawings much faster than with any other packaging design software. PackZ design components are parametrically driven and feature built-in intelligence, which includes the ability to automatically re-size when positioned.

Large and comprehensive libraries of pre-programmed, reusable parametric design styles are also included to enable speedy drawing and sample turnaround. PackZ standard libraries include corrugated (FEFCO), folding carton (ECMA), point of purchase display, rigid paper composite and media wallet variations.

PackZ's automatic layout feature is capable of calculating one, or multiple, interlocking nesting patterns simultaneously to ensure maximum efficiency and minimum material waste. This feature keeps track of material type and flute/grain direction to ensure that packaging designs maintain the correct orientation when added to a sheet.

Structural design is as much about experimentation as it is imagination, and PackZ's powerful 3D features enable users to combine both. 2D to 3D conversion is quick and easy and PackZ's advanced technology allows the production of realistic 3D prototypes.

PackZ supports the importing of a wide range of industry standard 3D solid objects, the creation of custom 3D product shapes, and the production of video animations.

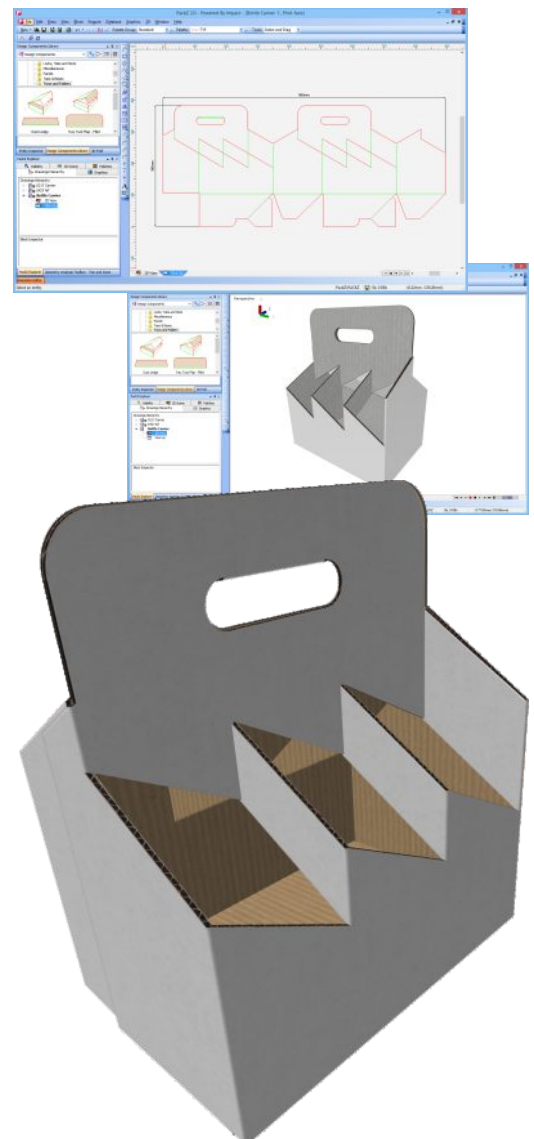

Call us to arrange a demonstration.